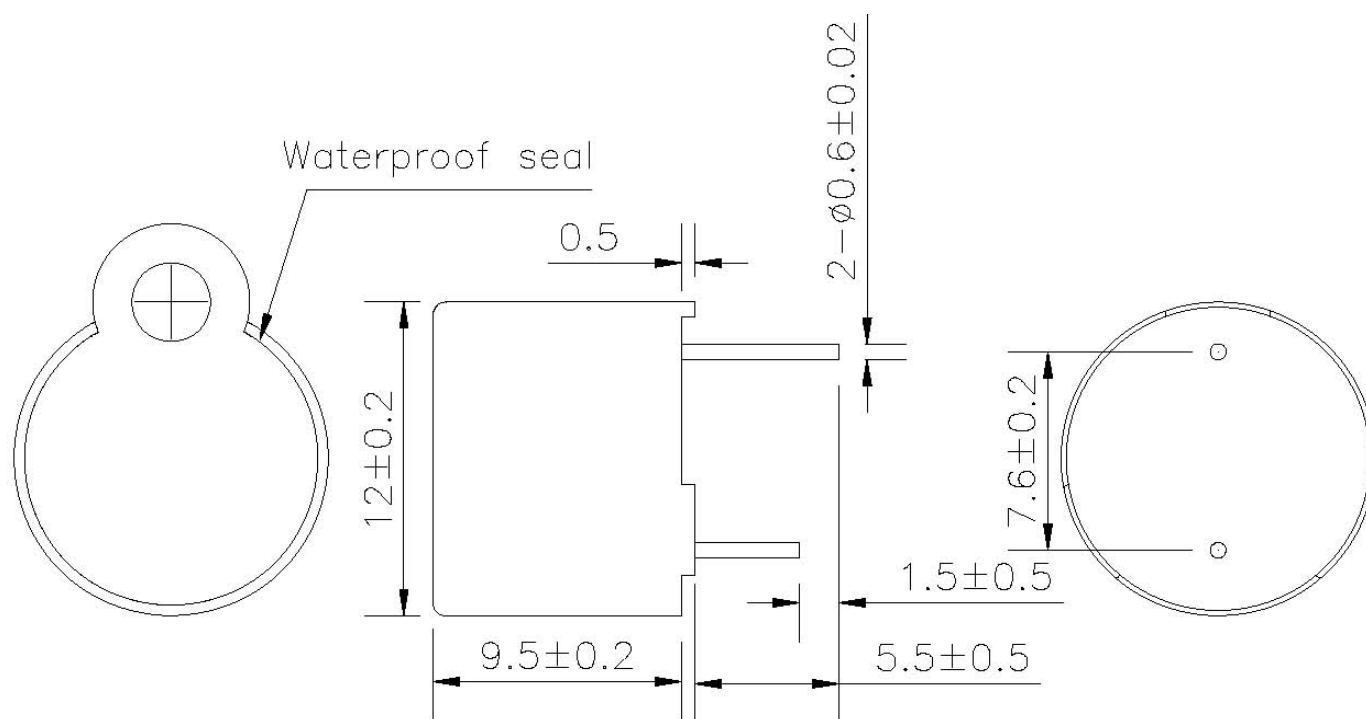

Sales Outline Drawing

**May not be suitable for all Medical and Aerospace applications.
Contact Mallory Sonalert to discuss your application.**

Oscillation Frequency (Hz)	2300 \pm 400
Operating Voltage (Vdc)	4.0 ~ 7.0
Rated Voltage (Vdc)	5
Current Consumption Max. (mA)	30 at Rated Voltage
Sound Pressure Level (dB/min)	85 at 10cm at Rated Voltage
Tone/Pulse Rate	Constant
Operating Temperature (°C)	-20 ~ +70
Storage Temperature (°C)	-30 ~ +80
Lead Pin	Tin Plated Brass
Housing	PPO plastic resin (Color: Black)
Weight (Grams)	1.8
Condition by wave soldering (°C)	245 \pm 5 / 3 \pm 0.5 sec
Condition by hand soldering (°C)	350 \pm 20 / within 5 sec
Options	For other options contact factory

Dimensions: (units: mm)**ROHS Compliant****Packaging:** Parts are supplied in tube (40 per tube).